

Table of Contents

Introduction	2
Important safety instructions	3
Description of the humidifier	5
Operating location of the humidifier, its assembly and filling the water tank	6
Using the humidifier	6
Cleaning and maintenance	7
Troubleshooting	8
Technical specifications	8
Explanation of symbols used on the product, its accessories and packaging	9
Instructions and information about the handling of used packaging	9
Affirmation about the issuance of a Declaration of Conformity	9

Introduction

- A humidifier effectively increases indoor air humidity and thereby improves air quality and has a positive effect on human health. It acts preventively against drying out of the mucous membrane in the respiratory tract and prevents respiratory problems, which makes it an ideal accessory helping you to care for your family's health. Its use is recommended primarily during the heating season, when, as a rule, indoor air is predominantly dry.
- The Bayby BBH 8010 Ultrasonic Aroma Air Humidifier was designed to not only be a good helper for caring parents, but also a pleasant designer accessory for a child's bedroom. The humidifying performance of the humidifier is adjustable and works on the principle of a 1.65–1.75 MHz high frequency ultrasonic oscillator. Thanks to this technology, it produces cold steam and does not affect the temperature in the room. The built-in colour LED light, together with the aroma of essential oils, which can be added into the water tank, create a pleasant indoor atmosphere. With a humidifying performance of 300 ml/h, it is suitable for use in rooms up to an area of 25 m². Its large 2.3-litre water tank guarantees an operating time of up to 7.5 hours per single refill. Silent operation allows your child to sleep without any interruption. When the water in the water tank is almost used up, the LED operating indicator is lit red and the humidifier turns off automatically.

Important safety instructions

Read carefully and store for future reference.

- This appliance may be used by children 8 years of age and older and by persons with physical or mental impairments or by inexperienced persons, if they are properly supervised or have been informed about how to use the product in a safe manner and understand the potential dangers. Children must not play with the appliance. Cleaning and maintenance that may be performed by the user must not be performed by unsupervised children.
- The appliance is designed for use in households, offices and similar types of areas. Always install it on an even, dry and stable surface. Do not place it in the vicinity of an open flame, gas appliances or devices that are sources of heat and do not expose it to direct sunlight.
- Before connecting the appliance to a power socket, check that the technical details on its rating label match the electrical voltage in the socket.
- Do not use the appliance in rooms where there is a risk of flammable gases or chemical vapours leaking or in rooms that are very dusty. When the appliance is running, it must be located at a sufficient distance from curtains or drapes and at least 2 metres from electrical or electronic devices or materials sensitive to moisture in order not to damage them by the effect of increased humidity.
- Do not replace any part of this appliance with parts or accessories from another manufacturer.
- Only fill the water tank with clean cold water. For aromatherapy, a few drops of essential oil can be added to the water. When choosing essential oils, always select high quality 100% natural essential oils intended for dispersion into the air. Use essential oils sparingly and carefully, paying attention to the instructions and notes on the packaging. For more information on the effects and correct dosage of essential oils, please contact your vendor or an expert. Do not add anything other than essential oils to the water in the water tank.
- Do not pour water into the water tank through the steam outlet.

- Before putting the appliance into operation, check that it is properly assembled and that the water tank is filled.
- Do not cover the appliance when it is running. Do not insert any objects into the steam outlet or the ventilation openings. Make sure that none of these openings are blocked by foreign objects.
- As a result of increased humidity in the room, water may condensate on window panes or interior furnishings. If this situation arises, turn the appliance off.
- Always turn off the appliance and disconnect it from the power socket, before filling up the water tank, installing, removing, moving or cleaning it.
- Be especially careful not to spill water when carrying the appliance with water in the water tank.
- To avoid potential injury by electrical shock, do not submerge any part of the appliance's base unit in water or any other liquid.
- Do not touch the nebulizer with sharp objects in order not to damage it.
- Do not disconnect the appliance from the power socket by pulling on the power cord. This could damage the power cord or the power socket. Disconnect the cord from the power socket by gently pulling on the plug of the power cord.
- If the power cord is damaged, have it replaced at a professional service centre. It is forbidden to use the appliance if it has a damaged power cord or plug.
- Do not use the appliance if it is not working correctly, if it has been damaged or has been submerged in water. To avoid the danger of injury by electrical shock, do not repair the appliance yourself or make any adjustments to it. Have all repairs of the appliance performed at an authorised service centre. By tampering with the appliance, you risk voiding your legal rights arising from unsatisfactory performance or quality warranty.
- We recommend saving the original box, packaging material, receipt and responsibility statement of the vendor or warranty card for the duration of warranty. It is appropriate to transport the appliance in its original box.

Description of the humidifier

A

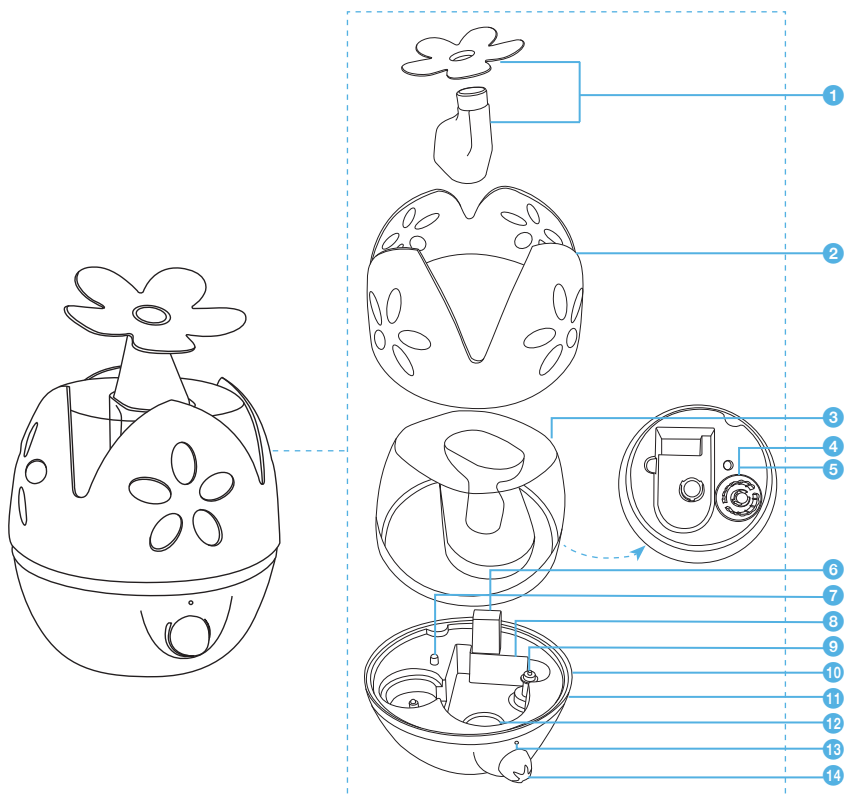

- | | |
|--|---|
| ① Steam exhaust nozzle | ⑨ Water level sensor |
| ② Water tank cover | ⑩ Base unit |
| ③ Water tank with a capacity of 2.3 l | ⑪ Switch I/O for turning the appliance on and off it is located at the rear of the base unit. |
| ④ Plug of the water tank filling opening with a water release switch | ⑫ Nebulizer
a surface where water is converted into cold steam (mist). |
| ⑤ Gasket seal
is located along the perimeter of the opening. | ⑬ Light indicator of operation and low water level in water holder |
| ⑥ Air exhaust opening | ⑭ Humidifying performance control dial |
| ⑦ Coloured LED light | |
| ⑧ Water holder
Water is pumped into the water holder from the water tank. | |

Operating location of the humidifier, its assembly and filling the water tank

- Always place the humidifier on an even, dry and stable surface and at the same time, maintain the following minimum clearances:
 - 60 cm from the floor;
 - 30 cm from walls or sides of furniture, from curtains and drapes;
 - 200 cm from electrical and electronic devices or materials sensitive to moisture to prevent their damage by the effects of increased humidity.
- Check that the humidifier is turned off and disconnected from the power socket. From the water tank A③ remove the nozzle A① and the cover A②. Lift the water tank A③ off the base unit A⑩. Turn it upside down and turn anticlockwise to unscrew the plug of the filling opening of the water tank A④ and remove it.
- Fill the water tank A③ with clean cold tap water. For aromatherapy, you can add a few drops of essential oil. When choosing essential oils, always select high quality 100% natural essential oils intended for dispersion into the air. Use essential oils sparingly and carefully, paying attention to the instructions and notes on the packaging. For more information on the effects and correct dosage of essential oils, please contact your vendor or an expert. Do not add anything other than essential oils to the water in the water tank A③.
- After filling up the water tank A③, properly secure the plug A④ by turning it clockwise. The water tank filling opening has a gasket seal A⑤. Before closing the water tank A③, always check that the gasket seal A⑤ is in its place. Turn the water tank A③ upside down with the plug A④ facing downwards and place it back on to the base unit A⑩ so that both parts fit into each other properly. When the water tank A③ is placed on the base unit A⑩, water will start to be pumped from the water tank A③ into the water holder A⑥.
- Place the cover A② with the steam outlet nozzle A① on to the water tank A③.



Attention:

Fill the water tank A③ with water no hotter than 40 °C. Do not fill it up with water that is hotter. The water tank A③ has a maximum capacity of 2.3 litres of water.

If you need to move the humidifier, be especially careful not to spill the water contained in the water holder A⑥.

Using the humidifier

- Make sure that the humidifier is correctly assembled and the water tank A③ is filled with water. Connect the power cord to a power socket. After connecting the humidifier to a power socket, the coloured LED light A⑦ will be lit. Set the I/O switch A⑪ to position I (On). Turn the control dial A⑭ clockwise to increase steam output and turn it anticlockwise to reduce steam output. The humidifier will start producing cold steam within a few moments. When green, the indicator light A⑬ signals that the humidifier is in operation. Ensure that during operation that the steam is not directed at furniture or items sensitive to moisture.
- You can increase or decrease the steam output at any time during operation. If you fill the tank A③ up to the edge, the expected operating time is up to 7.5 hours with the steam output set to maximum intensity.



Attention:

If the humidifier was transported at a temperature below the freezing point, first put it into room temperature and wait approx. 30 minutes before turning it on.

Use the humidifier at an ambient temperature of 5 to 40 °C and at a relative humidity of up to 60 %. In the event that the ambient temperature falls below 0 °C, turn the humidifier off and remove the water inside the water tank A③ and the water holder A⑥, to prevent it from being damaged.

Never lift the water tank A③ out of the base unit A⑩ or touch the nebulizer A⑫ when the humidifier is running.

3. If the water level in the water holder A⑥ runs low, the humidifier will automatically stop producing steam and the indicator light A⑬ will be lit red. This is a safety function to prevent the nebulizer A⑫ from being damaged. If necessary, fill up the water according to the instructions in point 2 and 3 in chapter Operating location of the humidifier, its assembly and filling the water tank. Then you can start the humidifier again.
4. When you have finished using it, always turn the humidifier off by turning the control dial A⑭ anticlockwise all the way and set the switch to position 0 (Off). The indicator light A⑬ turning off indicates that the humidifier is off. Disconnect the humidifier from the power socket. After disconnecting the humidifier from the power socket, the coloured LED light A⑦ will turn off. Clean out the humidifier according to the instructions in chapter Cleaning and maintenance.

Cleaning and maintenance

- Before cleaning the humidifier, turn it off and disconnect it from the power socket.
- Please adhere to the following instructions relating to the cleaning and maintenance of the humidifier. Otherwise its performance may be negatively affected and undesirable microorganisms may multiply inside the humidifier.
- **Clean after every use**
 - From the water tank A③ remove the nozzle A① and the cover A②. Take the water tank A③ out of the base unit A⑩ and take it to the sink. Turn it upside down and release the plug A④. Remove any remaining water from the water tank A③ and thoroughly rinse it out with clean water. Dry the surface of the water tank A③ with a fine wiping cloth and secure the plug A④.
 - Rinse the nozzle A① under clean running water and wipe dry with a fine wiping cloth.
 - Remove the water from the water holder A⑥ and if you added essential oils to the water when filling up the water tank A③, thoroughly wipe it out with a dampened wiping cloth to remove any oil residues. Then dry the water holder A⑥ using a fine clean cloth.
- **Thorough cleaning (once per week)**
 - Remove water from the water tank A③ and the water holder A⑥.
 - Pour approximately 100 ml of vinegar into the water holder A⑥ and allow it to act for 15 minutes. Using a brush with gentle bristles, remove the limescale deposits in the water holder A⑥ and the nebulizer A⑫. Then thoroughly clean out all the remaining limescale and vinegar using a cloth dampened in clean water and wipe dry.



Attention:

Do not leave water in the water tank A③ or in the water holder A⑥ for longer than one day.
Do not touch the nebulizer A⑫ with sharp objects in order not to damage it.
Do not submerge the base unit A⑩ in water or rinse it under running water.

- Clean the outer surface of the humidifier as required using a fine clean cloth lightly dampened in lukewarm water.
- For cleaning, do not use abrasive cleaning products and solvents as this could damage the surface of the appliance.

Troubleshooting

Problem	Possible cause	Solution
The humidifier is producing an insufficient amount of steam or is not producing any steam at all.	There is not enough water in the water holder A⑧ or there is no water at all.	Turn off the humidifier and disconnect it from the power socket. Fill up the water tank A③ with cold clean water. Connect the humidifier to a power socket and start it again.
	The control dial A⑭ is set to a low steam output intensity.	To increase the steam output intensity, turn the control dial A⑭ clockwise.
	The nebulizer A⑫ is soiled with mineral deposits or essential oil residues.	Turn off the humidifier and disconnect it from the power socket. Clean out the nebulizer A⑫ according to the instructions in chapter Cleaning and maintenance.
	The water tank A③ is not correctly seated in the base unit A⑩.	Place the water tank A③ on to the base unit A⑩ so that both parts fit together properly.
	The nebulizer A⑫ is not working.	Contact an authorised service centre.
An odour can be sensed in the steam.	The odour may be sensed when the humidifier is used for the first time.	Open the water tank plug A④ and allow the water tank A③ to ventilate for at least 12 hours.
	Inside the water tank A③ / water holder A⑧ there is dirty water or you have left water in the water tank A③ / water holder A⑧ for too long.	Turn off the humidifier and disconnect it from the power socket. Remove the water from the water tank A③ and the water holder A⑧. Clean everything. Fill up the water tank A③ with cold clean water. Connect the humidifier to a power socket and start it again.
Mineral deposits quickly accumulate on the nebulizer A⑫.	You are using water that is too hard.	Use softer water.

Technical specifications

Model number	BBH 8010
Rated voltage range	220–240 V
Rated frequency	50 Hz
Rated power input	25 W
Electrical shock protection class	II
Noise level	35 dB(A)
High-frequency oscillation	1.65–1.75 MHz
Water tank capacity	2.3 l
Operating time per full water tank	up to 7.5 h
Humidifier output	300 ml/h
Recommended room area	25 m ²
Ambient temperature	5 °C to 40 °C

The declared noise emission level of the appliance is 35 dB(A), which represents a level A of acoustic power with respect to a reference acoustic power of 1 pW.

Explanation of symbols used on the product, its accessories and packaging

 This symbol indicates that this appliance meets all the basic requirements of EU directives related to it.



This symbol indicates that the product has protection class II.



This symbol serves to designate the production lot number.



This symbol indicates the material from which the packaging is made.



This symbol informs the consumer about how to handle the packaging.



This symbol on products or original documents means that used electric or electronic products must not be added to ordinary municipal waste. For proper disposal, renewal and recycling hand over these appliances to determined collection points. Alternatively, in some European Union states or other European countries you may return your appliances to the local retailer when buying an equivalent new appliance. Correct disposal of this product helps save valuable natural resources and prevents potential negative effects on the environment and human health, which could result from improper waste disposal. Ask your local authorities or collection facility for more details. In accordance with national regulations penalties may be imposed for the incorrect disposal of this type of waste.

For business entities in European Union states

If you want to dispose of electric or electronic appliances, ask your retailer or supplier for the necessary information.

Disposal in other countries outside the European Union.

This symbol is valid in the European Union. If you wish to dispose of this product, request the necessary information about the correct disposal method from the local council or from your retailer.

Instructions and information about the handling of used packaging

Dispose of used packaging material at a site designated for waste in your municipality.

Affirmation about the issuance of a Declaration of Conformity

Fast ČR, a.s. Czech Republic declares that this product conforms to all requirements and directives of the EU and that a valid declaration of conformity was issued for it.

The Czech language is the original version of the user's manual. Changes to text and technical parameters are reserved.